

REVISIONS			
~	RELEASED FROM EX, CR 1453	11/06/01	JH
A	REVISED INTERNAL SPRING	12/07/01	JH
B	BUTTON MAT'L WAS ACETAL, CR1517	07/01/03	MA
C	UPDATE MATERIAL, CR1908	07/21/10	ERB

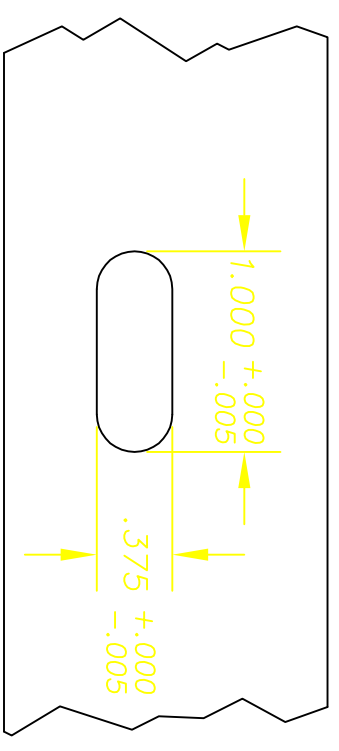

* SQUARE EDGE REQUIRED ON WING RETENTION SIDE OF SLOT

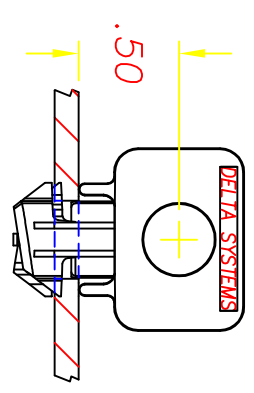

PUNCH ENTRY SIDE
RETENTION SIDE

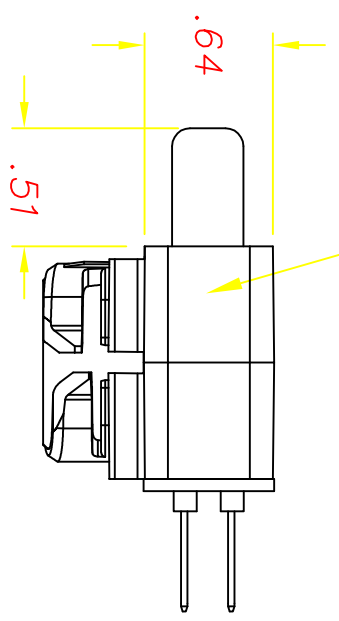

DATE CODE STAMPED ON BODY OF SWITCH

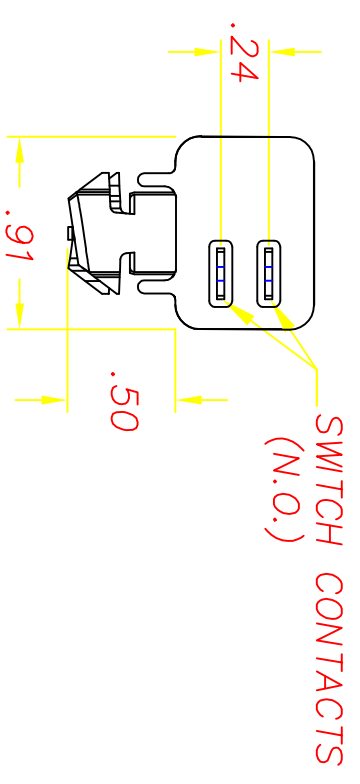

NOTES:

- 1- TERMINALS ARE NICKEL PLATED
- 2- PLASTIC PARTS ARE POLYPROPYLENE.
- 3- DATE CODE INDICATING YEAR, MONTH, AND DAY OF MONTH MANUFACTURED STAMPED ON HOUSING.
- 4- INTEGRITY OF WELD & SWITCH FUNCTIONALITY TESTED AFTER ASSEMBLY.
- 5- THIS PRODUCT COVERED BY ONE OR MORE OF THE FOLLOWING U.S. PATENTS: 5,221,816; 5,424,502; 4,812,604, OTHER PATENTS APPLIED FOR.
- 6- THIS SWITCH IS NOT RECOMMENDED FOR SAFETY INTERLOCK APPLICATIONS.
- 7- STATIC LOAD OF 1.1±0.4 LB EXERTS @ .150" DEFLECTION AT REST STATE OF PLUNGER.

.040-.150 TO MAKE OR BREAK CONTACTS

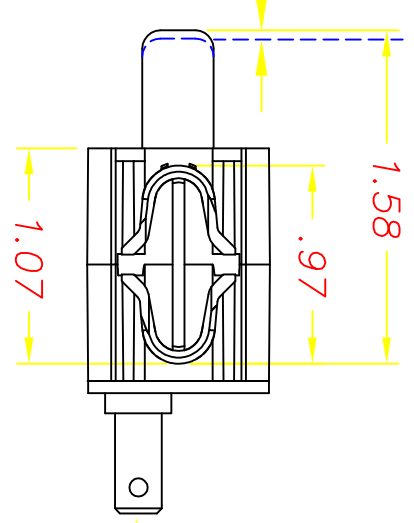

.250 x .032 MALE TERMINALS (4)
MATE WITH PACKARD 56 SERIES FEMALE. (NOTE 1)

DELTA SYSTEMS, INC. DOES NOT ASSUME ANY LIABILITY ARISING OUT OF THE MISAPPLICATION OF ANY PRODUCT		UNLESS OTHERWISE SPECIFIED DIMENSIONS ARE IN INCHES TOLERANCES ARE: .XX± .02 .XXX± .005 ANGE 1°	
COMPUTER GENERATED DRAWING - NO MANUAL CHANGES ALLOWED	DO NOT SCALE DRAWING	DRAWN DMR	DATE 09/12/01
FINISH BLACK		CHECKED JH	DATE 11/06/01
MATERIAL AS NOTED		TITLE N.O. PLUNGER SWITCH S.P.S.T. W/ 2.0 LB SPRING	
SIZE B		DWG. NO. 6400-20	
SCALE FULL		PROJECT NO. EX335	
DELTA SYSTEMS INC. STREETSBORO, OHIO 44241		REV C	