

DWG. NO.	SH	REV.	COMPUTER GENERATED DRAWING - NO MANUAL CHANGES		
			REVISIONS		
	C		REVISED HOUSING, CR 817	7/12/96	TW
	D		ADDED NAME TO HOUSING, CR1017	08/17/97	TW
	E		UPDATE MATERIAL, CR1908	07/21/10	ERB

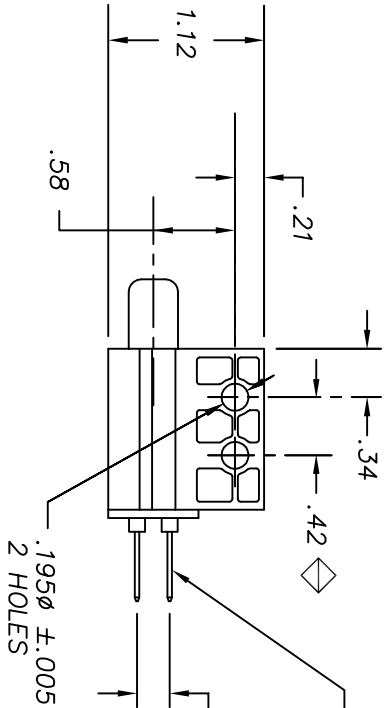
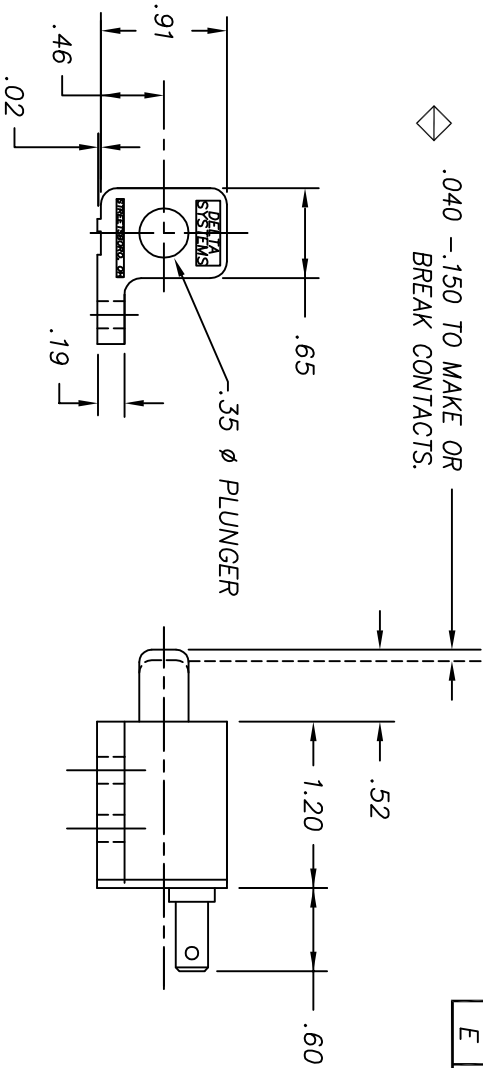

250 x .032 MALE SPADE TERMINALS -
MATE WITH PACKARD 2-WAY
CONNECTOR #2973872.

NOTES:

- 1 - TERMINALS ARE NICKEL PLATED.
- 2 - PLASTIC PARTS ARE POLYPROPYLENE.
- 3 - DATE CODE INDICATING YEAR, MONTH, AND DAY OF MONTH MANUFACTURED STAMPED ON HOUSING.
- 4 - INTEGRITY OF WELD & SWITCH FUNCTIONALITY TESTED AFTER ASSEMBLY.
- 5 - THIS PRODUCT COVERED BY THE FOLLOWING U.S. PATENT; 4,812,604. OTHER PATENTS APPLIED FOR.

DELTA SYSTEMS, INC. DOES NOT ASSUME ANY LIABILITY ARISING OUT OF THE MISAPPLICATION OF ANY PRODUCT UNLESS OTHERWISE SPECIFIED. DIMENSIONS ARE IN INCHES. TOLERANCES ARE:
 .XXX .020 .XXX .010 ANG

DRAWN	DATE
GAS	06/10/91
CHECKED	DATE
TW	06/10/91
MATERIAL	NOTE 2
FINISH	GRAY

 DELTA SYSTEMS INC. STREETSBORO, OHIO 44241		TITLE 6400-54 N.O. PLUNGER SWITCH	
SIZE	DWG. NO.	PROJECT NO.	REV.
B	6400-54	EX311	E
SCALE	SHEET	OF	
FULL	1	1	

DO NOT SCALE DRAWING