

REVISIONS			
REV.	DESCRIPTION	DATE	INIT
0	INITIAL RELEASE	01/27/20	NMP

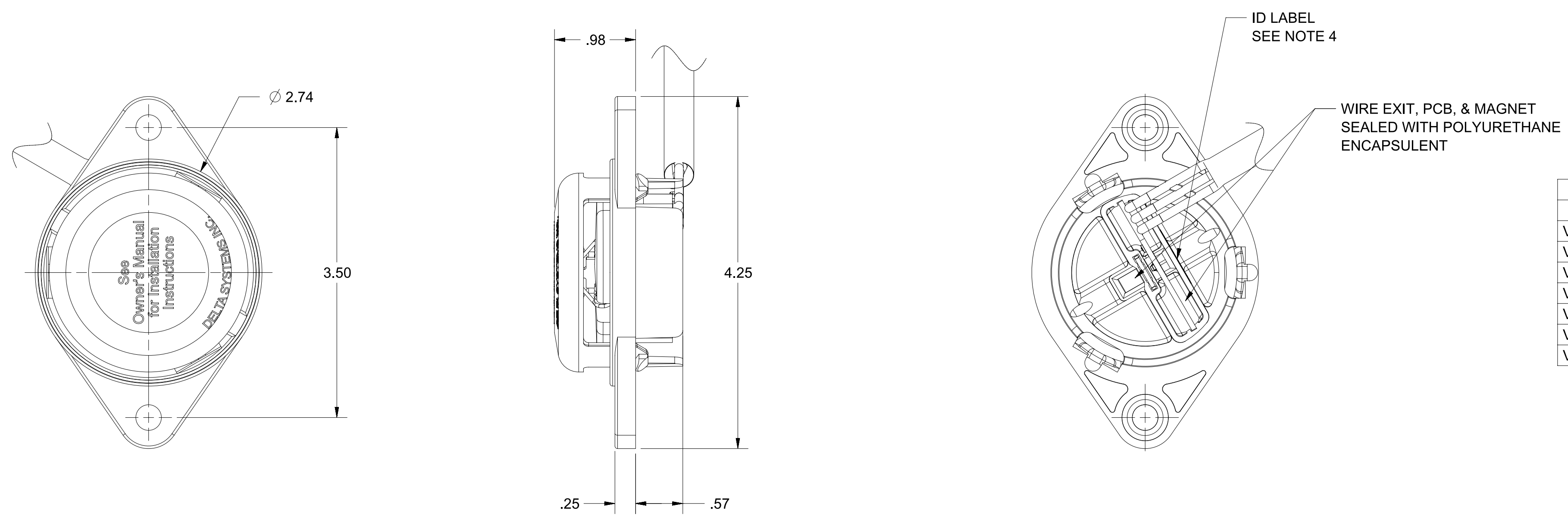

VOLTAGE OUTPUT	
VOUT (VIN = 12 VDC, LOAD = 8930 OHMS)	DESCRIPTION
VOUT LESS THAN 0.5	OPEN CIRCUIT OR SHORTED TO GROUND
VOUT GREATER THAN OR EQUAL TO 0.5, LESS THAN 0.9	INVALID VALUE
VOUT GREATER THAN OR EQUAL TO 0.9, LESS THAN 1.85	SEAT OCCUPIED
VOUT GREATER THAN OR EQUAL TO 1.85, LESS THAN 2.5	INVALID VALUE
VOUT GREATER THAN OR EQUAL TO 2.5, LESS THAN 4.15	SEAT VACANT
VOUT GREATER THAN OR EQUAL TO 4.15, LESS THAN 4.9	INVALID VALUE
VOUT GREATER THAN OR EQUAL TO 4.9	SHORTED TO VIN

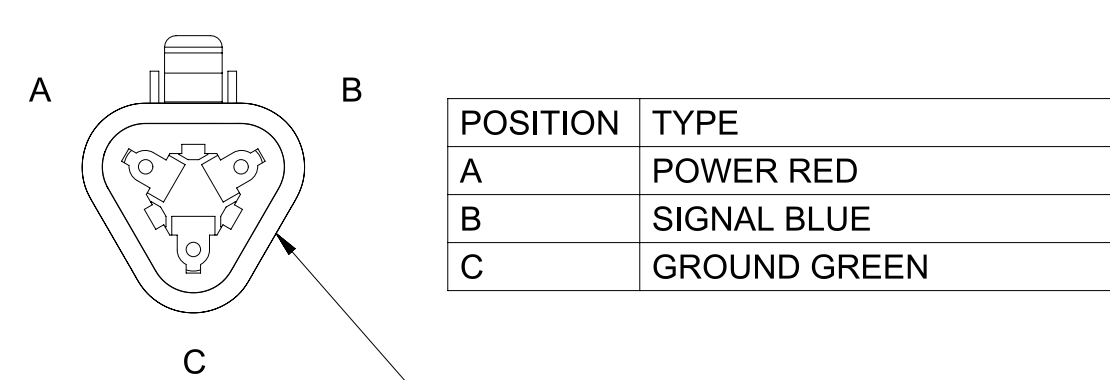

POSITION	TYPE
A	POWER RED
B	SIGNAL BLUE
C	GROUND GREEN

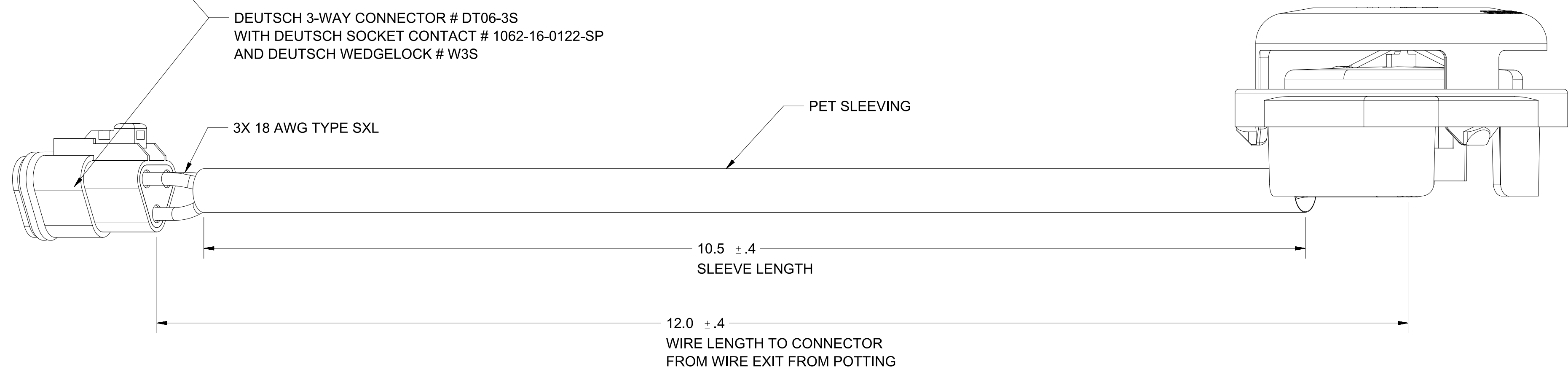

FULL VIEW OF ASSEMBLY
1.5X SCALE

NOTES

- .10-.20 MOTION TO CAUSE CHANGE OF ELECTRICAL STATE.
- PLASTIC PARTS ARE POLYPROPYLENE
- ELECTRICAL CONNECTION- WIRE WITH DEUTSCH 3-WAY CONNECTOR
- ID LABEL CONTAINING DELTA P/N AND DATE CODE INDICATING YEAR, MONTH AND DAY OF MONTH MANUFACTURED APPLIED TO MOUNTING FRAME
- DELTA IS RESPONSIBLE FOR COMPLIANCE TO THIS SPECIFICATION. THE FUNCTION AND ADEQUACY OF THE SAFETY "SYSTEM" IN WHICH THIS COMPONENT IS USED IS THE RESPONSIBILITY OF THOSE THAT DESIGN AND BUILD THE SYSTEM (INCLUDING BUT NOT LIMITED TO THE SEAT DESIGN, SWITCH LOCATION, FOAM DENSITY AND DESIGN)
- MECHANICAL:
LIFE: 1,000,000 CYCLES
OPERATING FORCE: 0.5-3.0 LBS TO CAUSE CHANGE OF ELECTRICAL STATE
- ELECTRICAL:
OPERATING VOLTAGE: 8V - 16V
OVER-VOLTAGE: PER ASAE EP455 5.10.2 LEVEL 1
REVERSE POLARITY: PER ASAE EP455 5.10.3
SHORT-CIRCUIT PROTECTION: PER ASAE EP455 5.10.4
POWER-UP OPERATIONAL REQUIREMENTS: PER ASAE EP455 5.10.7
ELECTROSTATIC DISCHARGE: PER ASAE EP455 5.12.1 LEVEL 2
- ENVIRONMENTAL:
OPERATING TEMPERATURE: -40°C - 85°C
STORAGE TEMPERATURE: -40°C - 90°C
HUMIDITY: PER ASAE EP455 5.13.2
VIBRATION: 10 G, 50 TO 1000 HZ, 2 MINUTE SCAN AT 25°C, 20 HRS EACH DIRECTION
DUST: PER ASAE EP455 5.3 LEVEL 2
IMMERSION: PER ASAE EP455 5.5 LEVEL 1
WASH: PER ASAE EP455 5.6 LEVEL 1
SALT: PER ASAE EP455 5.9 LEVEL 2
- INTERPRET DRAWING IN ACCORDANCE WITH ASME Y14.5-2009
- MUST BE IN COMPLIANCE WITH DIRECTIVE 2011/65/EU OF THE EUROPEAN PARLIAMENT AND THE COUNCIL OF 08 JUNE 2011 ON THE RESTRICTION OF THE USE OF CERTAIN HAZARDOUS SUBSTANCES IN ELECTRICAL AND ELECTRONIC EQUIPMENT (ROHS DIRECTIVE)

PROPRIETARY & CONFIDENTIAL THE INFORMATION CONTAINED IN THIS DRAWING IS THE SOLE PROPERTY OF DELTA SYSTEMS. ANY REPRODUCTION IN PART OR AS A WHOLE WITHOUT THE WRITTEN PERMISSION OF DELTA SYSTEMS IS PROHIBITED. DELTA SYSTEMS INC. DOES NOT ASSUME ANY LIABILITY ARISING OUT OF THE MISAPPLICATION OF ANY PRODUCT	UNLESS OTHERWISE SPECIFIED DIMENSIONS ARE IN INCHES TOLERANCES ARE: .X± .1 .XX± .02 .XXX± .005 X"± 1	DRAWN npurdy	DATE 27-Jan-2020	DELTA SYSTEMS 1734 FROST ROAD STREETSBORO, OHIO 44241 330-626-2811 WWW.DELTASYSTEMSINC.COM
		CHECKED bkroll	DATE 27-Jan-2020	
COMPUTER GENERATED DRAWING - NO MANUAL CHANGES ALLOWED	DO NOT SCALE DRAWING	APPROVED kirkaway	DATE 04-Feb-2020	TITLE SEAT SWITCH, HALL EFFECT
		AS NOTED	PROJECTED VIEWS ARE 3RD ANGLE	SHEET 1 OF 1
		PART 	DRAWING NO. 6540-008_APP	REVISIONS 142
		DESIGNED DS4_Design	SHEET 1 OF 1	REVISIONS 0