

REVISIONS

REV.	DESCRIPTION	DATE	INIT
0	INITIAL RELEASE	05/31/2016	BEK
1	BODY COLOR WAS BLACK, ECO 470	04/12/17	IDK
2	MATING MOLEX CONNECTOR 33472-4801 WAS 33472-0801	07/25/23	PJC

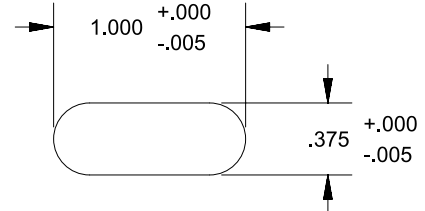

RECOMMENDED MOUNTING SLOT SWITCH WILL ACCEPT .108 PANEL THICKNESS INCLUDING PAINT, DECALS, ETC

*SQUARE EDGE REQUIRED ON WING RETENTION SIDE OF SLOT

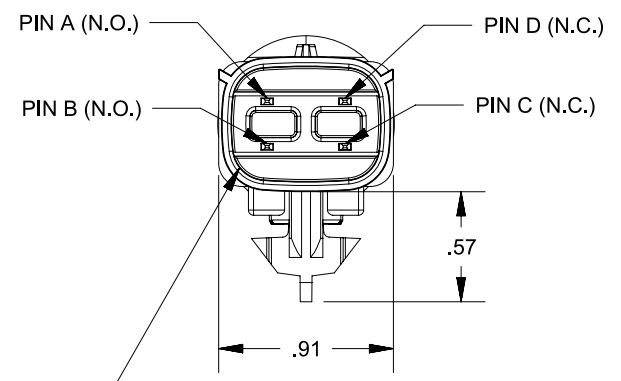
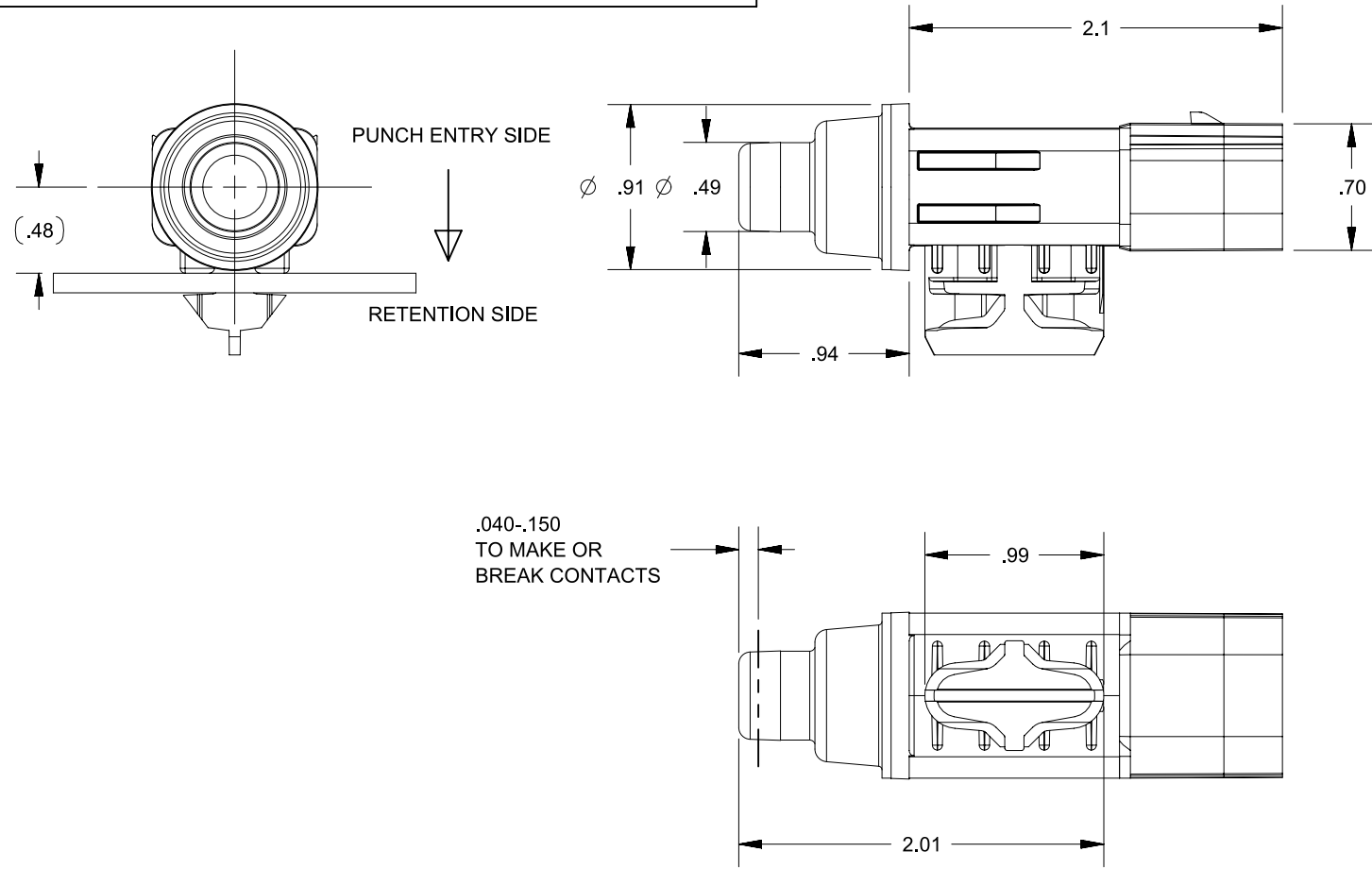

HARNESS INFORMATION
 SWITCH MATES WITH MOLEX MX150 SERIES ASSEMBLY # 33472-4801
 PIN A - MOLEX TERMINAL 1
 PIN B - MOLEX TERMINAL 5
 PIN C - MOLEX TERMINAL 8
 PIN D - MOLEX TERMINAL 4

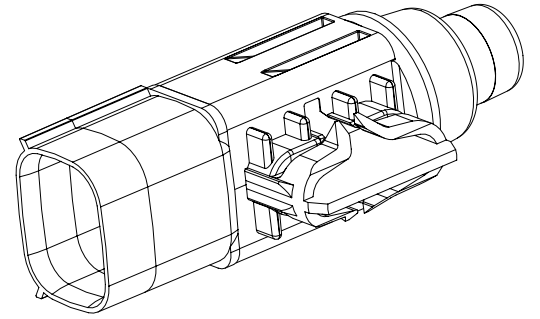

- NOTES**
- 1) TERMINALS ARE NICKEL PLATED
 - 2) DATE CODE INDICATING YEAR, MONTH, AND DAY OF MONTH MANUFACTURED MARKED ON HOUSING
 - 3) INTEGRITY OF WELD & SWITCH FUNCTIONALITY TESTED AFTER ASSEMBLY
 - 4) ASSEMBLY IS RoHS COMPLIANT.
 - 5) SWITCH PASSES IEC IP67
 - 6) EACH ASSEMBLY IS LEAK TESTED BY PRESSURIZING (WITH AIR) THE INTERNAL VOLUME TO 2 PSIG. SWITCH MUST MAINTAIN AIR VOLUME WITHIN 0-1 SCC/MIN RATE OF CHANGE
 - 7) DESIGN FOR A SWITCH BOUNCE OF 30ms
 - 8) THE BODY AND BACK COVER ARE GRAY, PLUNGER IS BLACK
 - 9) ACTUATION FORCE 5.0-7.5 LBS AT .400 PLUNGER TRAVEL WITH SEALED CONNECTOR INSTALLED
 - 10) TOTAL TRAVEL OF PLUNGER IS .40 MIN FROM REST POSITION
 - 11) INTERPRET THIS DRAWING IN ACCORDANCE WITH ASME Y14.5-2009

PROPRIETARY & CONFIDENTIAL THE INFORMATION CONTAINED IN THIS DRAWING IS THE SOLE PROPERTY OF DELTA SYSTEMS. ANY REPRODUCTION IN PART OR AS A WHOLE WITHOUT THE WRITTEN PERMISSION OF DELTA SYSTEMS IS PROHIBITED.	UNLESS OTHERWISE SPECIFIED DIMENSIONS ARE IN INCHES TOLERANCES ARE: .X± .1 .XX± .02 .XXX± .005 X°± 1°	DRAWN bkirkman	DATE 31-May-2016	DELTA SYSTEMS 1734 FROST ROAD STREETSBORO, OHIO 44241 330-626-2811 WWW.DELTASYSTEMSINC.COM			
		CHECKED bwetrich	DATE 31-May-2016				
APPROVED ikirbawy	DATE 01-Jun-2016	MATERIAL -	PROJECTED VIEWS ARE 3RD ANGLE 				
DELTA SYSTEMS INC. DOES NOT ASSUME ANY LIABILITY ARISING OUT OF THE MISAPPLICATION OF ANY PRODUCT	COMPUTER GENERATED DRAWING - NO MANUAL CHANGES ALLOWED	FINISH -	DO NOT SCALE DRAWING	STATUS DS4_Design	TITLE Sealed Rail Frame Plunger Switch	SIZE B	DWG. NO. 6470-84_APP
				SCALE NTS	SHEET 1 OF 1	PROJECT NO. 046	REVISION 2